

Low flow remedies for the 25.5xx two handle, in-wall mixers

This guide has been printed to help the installing contractor or homeowner to clean dirt out of this Grohe valve.

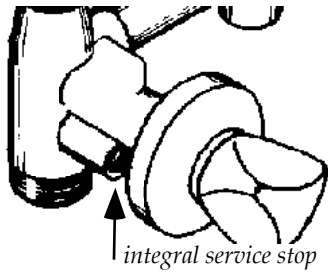

1) **Open the stops.** Yep, slow flow is usually caused by having partially closed integral service stops. The stops are located on the valve body (casting) directly below the stems. The tile-setter might have covered them, but they're there! Open them by turning counter-clockwise with a screwdriver until they touch the copper snap-ring.

Debris (rust, dirt, gravel) from the water supply can restrict the flow through the 25.500 series valve. The debris will catch in or around the annulus, an internal part that causes water to flow downward to the diverter spout before flowing upwards to the shower head.

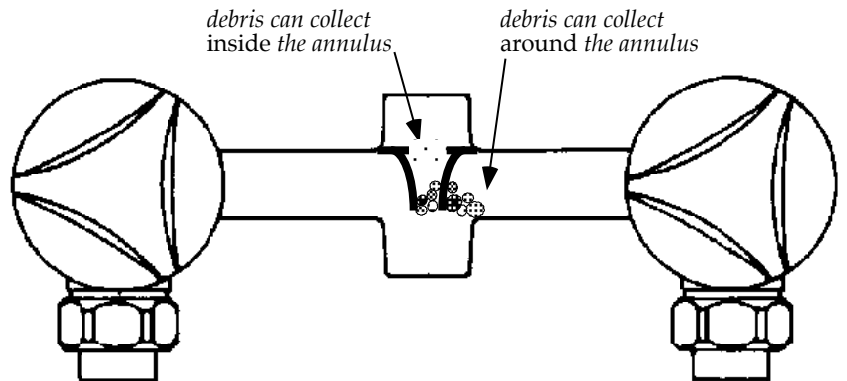

2) The debris can usually be removed by back-flushing the valve through the shower arm with a garden hose. Turn off the stops and remove the stems to allow the junk to flush out of the valve.

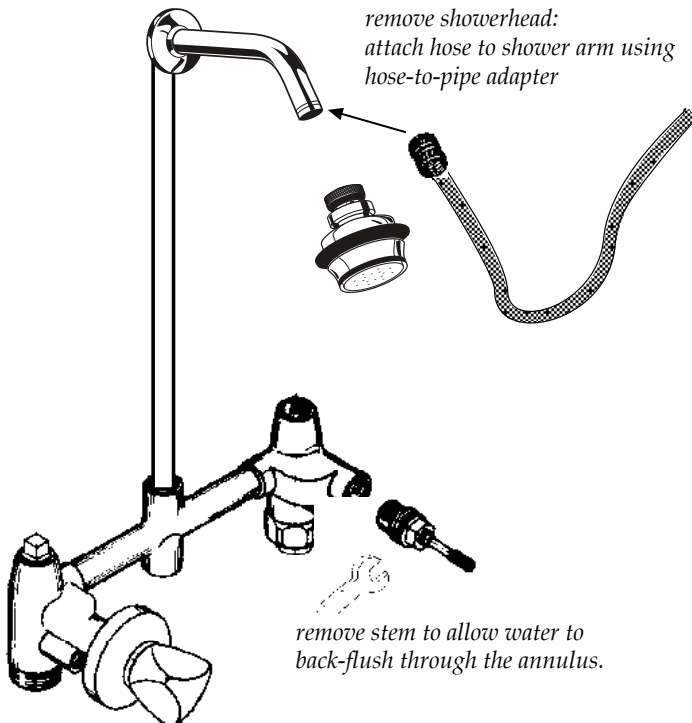

3) In extreme cases, remove the shower riser from the top outlet of the valve, and unscrew the annulus from the top. You can then flush out the valve and pick the rocks out of the annulus. When using the valve as a tub & shower set, you must reinstall the annulus.

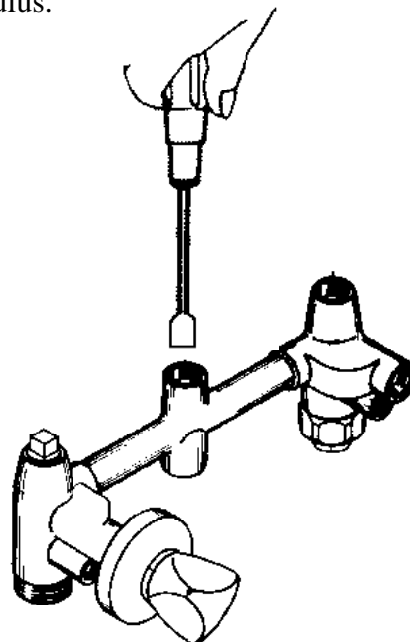

Western Sales Company
(408) 353-9000